



# WESTHAVEN

An exclusive cul-de-sac community in Ridgefield, WA, with spacious 10,000 to 13,000 SQFT home sites, ideally suited for executive luxury homes.



The Kingston team has decades of combined building and development experience in Clark County. Our knowledge and expertise are poured into every plan, detail and decision when building your new custom home.



Kingston Homes has several fabulous communities throughout Clark County offering green belt lots, community parks, and top rated schools.

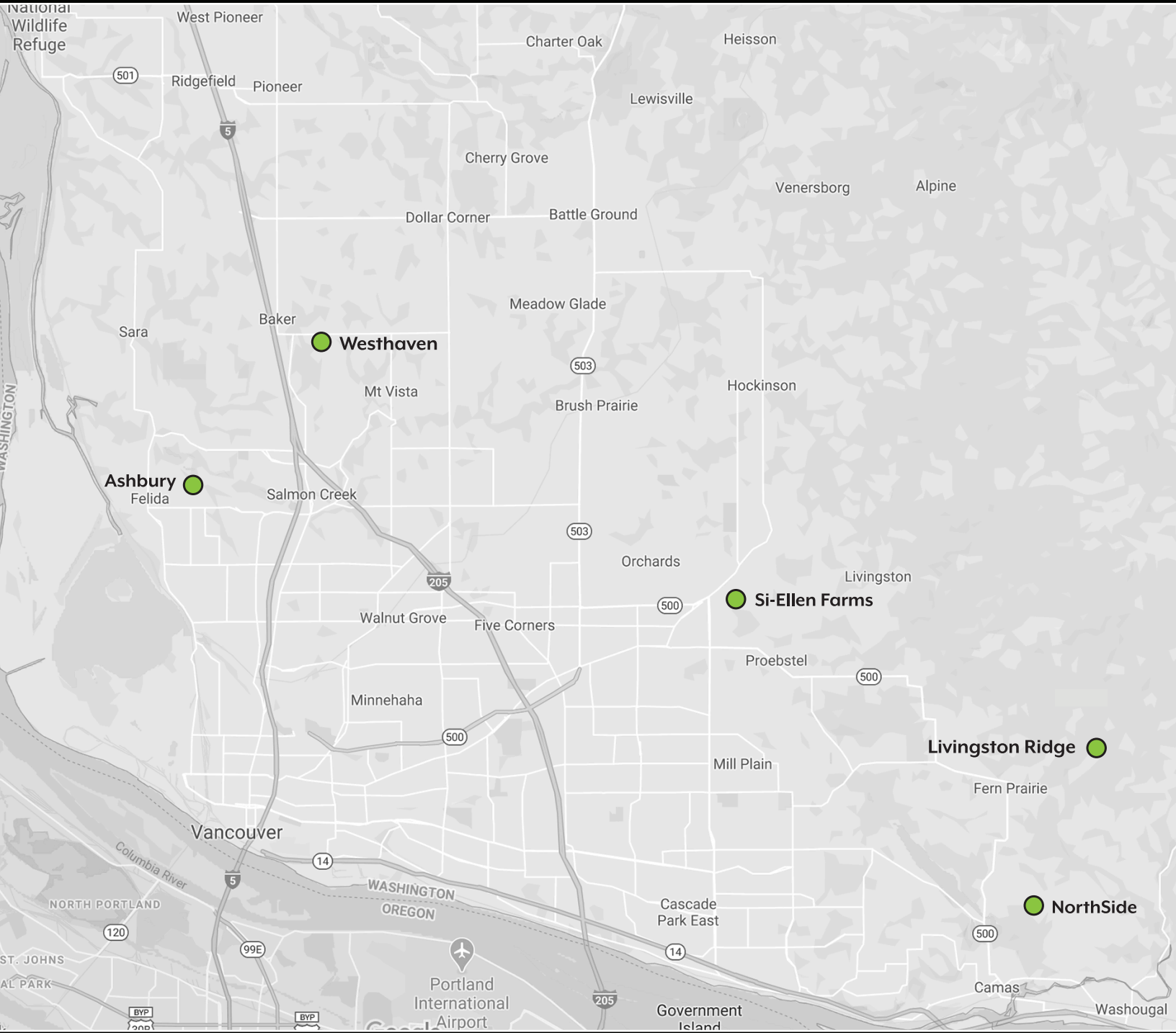

A hallmark of Kingston Homes is our attention to quality and detail. Our custom homes are built to the highest of standards and expectations.



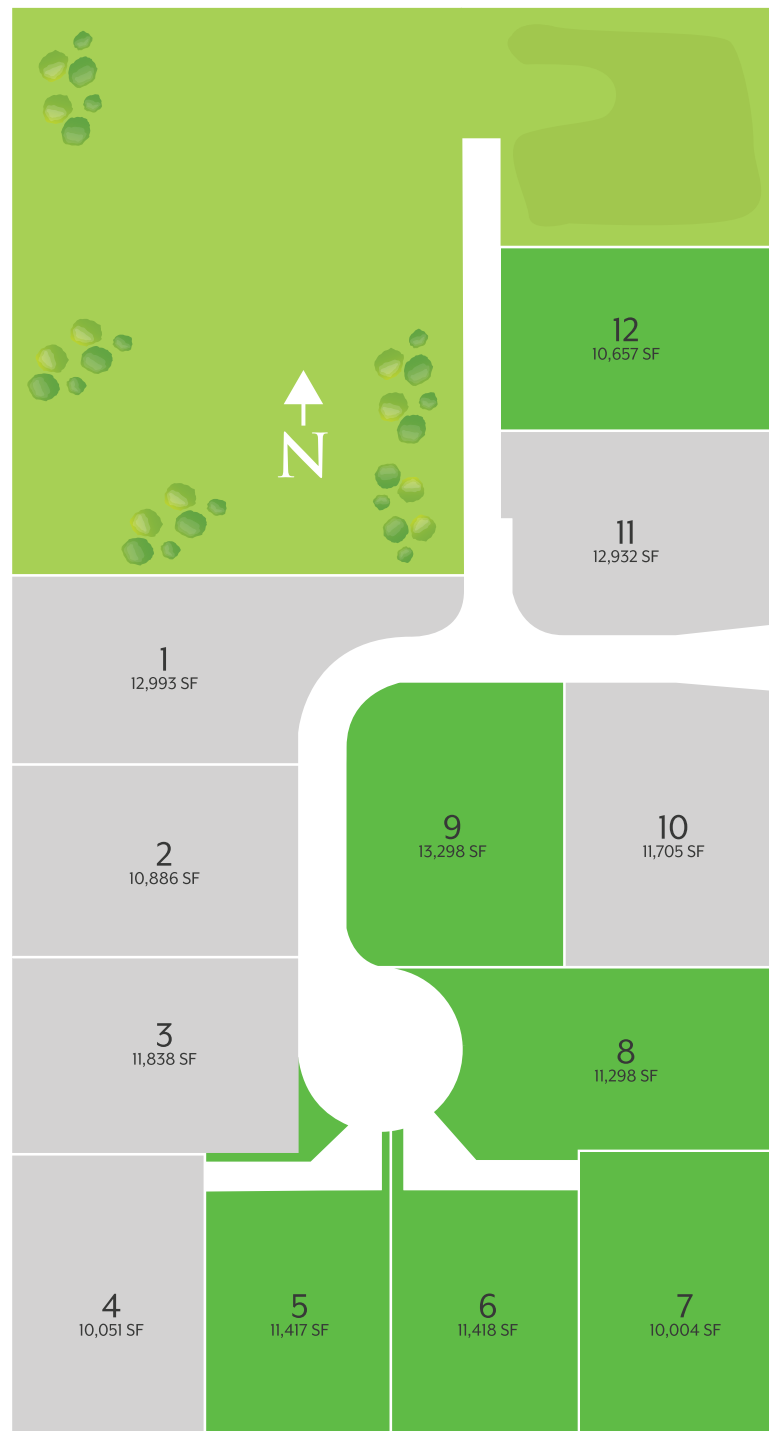

● Available Lot

Please inquire for custom pricing.

Chris Galyon | Sales Manager  
 (360) 521-7565  
 Chris@KingstonHomesLLC.com

### FRAMING

- 10' Ceilings First Floor (Per Plan)
- Raised Ceilings in Entry and Primary Suite (Per Plan)
- 9' Ceilings Second Floor (Per Plan)
- Oversized Windows

### MILLWORK PACKAGE

- 2,3 or 5-Panel Faux Wood Doors 8' Doors
- 6" Base with 3.5" Mitered Door/Window Casing
- Deluxe Millwork Package with Fully Wrapped Windows
- Painted Woodwork in Closets and Pantry

### KITCHEN

- Slab Granite or Quartz Counters
- Delta or Essa Arctic Stainless Kitchen Faucet
- Stainless Steel Under-Mount Kitchen Sink
- Garbage Disposal
- Plumbed for Ice Maker
- Kitchen Aid Stainless Built-In Oven, Microwave, Dishwasher, Refrigerator
- 5-Burner Gas Cooktop w/Broan Range Hood

### CABINETS

- Oversized Custom Cabinetry
- Stained Alder or Beechwood Cabinet Allowance (Per Plan)
- Soft Close Drawers Throughout
- Solid Wood Drawer Boxes
- Staggered Height Cabinetry Design

### BATHROOM

- Tile Flooring
- Slab Quartz/Granite Counter Tops in Full Baths
- Mud-Set Tiled Master Bath Shower w/ Frameless Glass System
- Tile Walled Tub Shower/Tile Showers in Secondary Baths
- Rectangle Undermount Sinks
- Gerber Elongated Toilets
- Delta Ashlyn or Lahara or Kyra BN or Chrome Bath Fixtures & Hardware

### FLOORING

- Custom Hard Surface and Flooring Allowance
- Waterproof Laminate or Engineered Hardwood Floors in Kitchen, Nook, Great Room, Lower Floor Halls and Entry (Per Plan)
- Extensive Selection of Various Pocolain Tile

### FIREPLACE

- Gas Fireplace with Tile Surround and Floating Mantel

### LIGHTING & PAINT

- Custom Lighting Allowance
- Kitchen/Great Room Can Lights (10) Included
- Textured and Painted Interior Garage Walls
- One Interior Paint Color for Walls with White Ceilings & Trim

### LOW VOLTAGE

- 5.0 surround speakers
- 2 locations RG-6
- 5 locations CAT 6
- Central Networking Panel
- Pre-wire Subwoofer
- Pre-wire Wireless Access Point
- Pre-wire Security Panel
- Smart Keyless Entry Lock
- Smart Thermostat

### ENERGY EFFICIENCY

- Electric Heat Pump For Heating and Cooling
- 80 Gallon Energy Efficient Heat Pump Hot Water Heater
- Energy Recovery Ventilation System
- Energy Efficient Vinyl Windows
- R-23 (BIBS) Insulation in Walls
- R-38 Insulation in Floors
- R-49 Insulation in Ceilings

### EXTERIOR & MECHANICAL

- 3-Car Garages (Design and Size Per Plan)
- Covered Back Patios (Per Plan)
- Full Front and Backyard Landscaping
- Full Front and Backyard Sprinkler Systems
- Backyard 6' Pre-Stained Cedar Fencing
- Limited Lifetime Architectural Black Roofing
- Tyvek Weather Wrapped Exterior
- Complete Fiber Cement Siding with Three (3) Exterior Paint Colors
- Painted Hardi Shake or Board and Batt Accents
- Wayne Dalton 9605 Insulated Garage Doors
- Garage Door Opener with Keyless Entry
- Garage Doors with Windows and Black Hardware
- Stone at Front Elevation (Per Plan)
- Stained Wood Front Door with or without Glass
- Crawl Space Foundation
- 2x6 Construction
- Kiln Dried Lumber
- I-Joist Engineered Floor Systems
- Fascia Boards at all Overhangs
- Perimeter Foundation Drains